

Ellsbridge Close, Keynsham, Bristol, BS31

Approximate Area = 1529 sq ft / 142 sq m
Outbuilding = 138 sq ft / 12.8 sq m
Total = 1667 sq ft / 154.8 sq m

For identification only - Not to scale

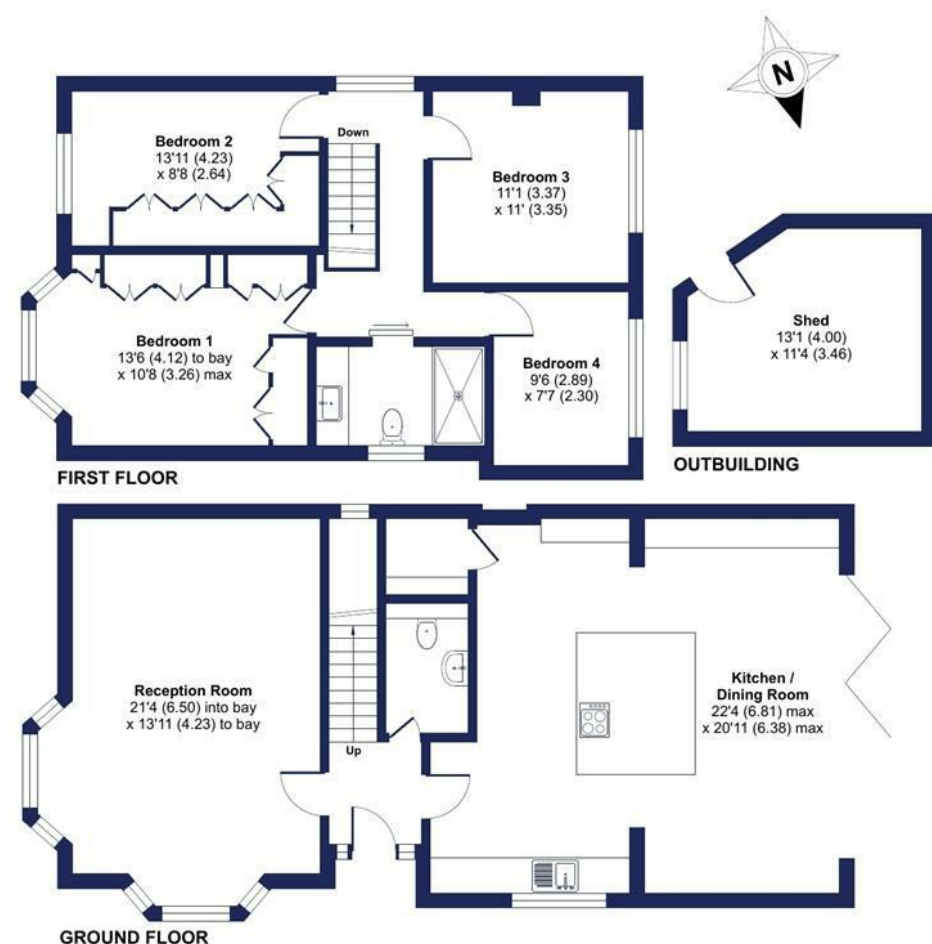

Floor plan produced in accordance with RICS Property Measurement 2nd Edition, incorporating International Property Measurement Standards (IPMS2 Residential). © nichecom 2025. Produced for Davies & Way. REF: 1255887



www.daviesandway.com

CONSUMER PROTECTION FROM UNFAIR TRADING REGULATIONS 2008

These details are for guidance only and complete accuracy cannot be guaranteed. If there is any point which is of particular importance verification should be obtained. They do not constitute a contract or part of a contract. References to tenure of a property are based on information supplied by the seller. The agent has not had sight of the title documents. A buyer is advised to obtain verification from their conveyancer. All measurements are approximate and floor plans are for guidance only. No guarantee can be given with regard to planning permissions or fitness for purpose. No apparatus, equipment, fixture or fitting has been tested. Photographs may have been taken using a wide angled lens and items shown in photographs are NOT necessarily included. Interested parties are advised to check availability and make an appointment to view before travelling to see a property. The property is offered subject to being unsold.

DATA PROTECTION ACT 1998: Please note that all personal information by customers wishing to receive information and/or services from Davies and Way will be processed by the agent and may be shared with third parties. If you do not wish your personal information to be used for any of these purposes, please notify us.

www.daviesandway.com

DAVIES & WAY

CHARTERED SURVEYORS • ESTATE AGENTS

489 Bath Road, Saltford, Bristol, BS31 3BA
Tel: 01225 400400 email: saltford@daviesandway.com

Lyndhurst, 1 Ellsbridge Close, Keynsham, Bristol, BS31 1TB



£650,000

An individual detached house dating from the 1930's occupying a pleasant corner plot location within walking distance of Waitrose and the Wellsway School complex.

- Stylishly presented & much improved offering spacious family accommodation
- Entrance Hall
- Downstairs cloakroom/WC
- Dual aspect sitting room with media wall
- Superb kitchen, dining and family room with bifold doors to rear garden
- 4 bedrooms
- Luxury shower room
- Corner plot with southerly facing rear garden
- Ample off street parking on block paved driveway
- Unappreciated unless viewed



www.daviesandway.com

Lyndhurst, 1 Ellsbridge Close, Keynsham, Bristol, BS31 1TB

Lyndhurst is an attractive double bay fronted detached house on a prominent corner plot location in Ellsbridge Close set back from the Bath Road. The property is stylishly presented and is an ideal family home with four bedrooms and a shower room on the first floor while on the ground floor there is a large dual aspect sitting room to the front of the property and a superb, large open plan family kitchen and dining room opening through bifold doors onto the rear garden. Externally the property stands in a good size corner plot with level gardens and blocked paved driveway facilitating ample off street parking. There is scope to construct a garage subject to obtaining necessary consents.

The property is in an ideal location for commuting to both Bristol and Bath and within walking distance of the Wellsway School complex and local amenities including Waitrose.

GROUND FLOOR

OPEN RECESSED PORCH:

Composite entrance door with double glazed side and top panels leading to

HALLWAY:

Dado rail, double panel radiator, coved ceiling, tiled floor, staircase rising to first floor.

CLOAK/WC:

Extractor, heated towel rail, tiled floor. Contemporary suite in white comprising wc with concealed cistern and wash hand basin with mixer tap and cupboard beneath.

SITTING ROOM: 6.50m into bay x 4.23m into bay (21'3" into bay x 13'10" into bay)

Double glazed bay windows to front and side aspects and further double glazed window to front. A light and spacious room with a media wall (television excluded) and two double panel radiators.

SUPERB OPEN PLAN FAMILY KITCHEN/DINING ROOM 6.81m x 6.38m (22'4" x 20'11")

Double glazed window to side aspect with 5 panel bifold double glazed doors opening onto the terrace and rear garden. Vertical and horizontal designer radiators, ceiling mounted downlighters and tiled floor. Deep understairs cupboard (excluded from measurements) The kitchen is beautifully fitted with a range of luxury units with contrasting quartz work surfaces. Extensive drawer and cupboard storage space. Inset stainless steel sink with mixer tap, integrated dishwasher, washing machine and tumble dryer. Concealed gas fired boiler. Feature island unit with breakfast bar over hang, integrated recycle drawer, induction hob and extractor. Twin eye level ovens, microwave, pull out larder units and space for American style fridge flanked by wine racks.

FIRST FLOOR

LANDING:

Double glazed window, contemporary glass and stainless steel balustrade, dado rail, ceiling mounted downlighters, access to roof space.

BEDROOM ONE: 4.12m into bay x 3.26m (13'6" into bay x 10'8")

Double glazed bay window to front aspect, double panel radiator. Excellent range of built in wardrobes (included in measurements) .

BEDROOM TWO: 4.23m x 2.64m (13'10" x 8'7")

Double glazed window to front aspect, radiator, picture rail, extensive range of built in wardrobes (included in measurements). Presently used as a dressing room.

BEDROOM THREE: 3.37m x 3.35m (11'0" x 10'11")

Double glazed window overlooking the rear garden, radiator, picture rail.

BEDROOM FOUR: 2.89m x 2.30m (9'5" x 7'6")

Double glazed window to rear aspect, radiator. Range of built in furniture including wardrobe, drawer storage, open shelving and desk (included in measurements)

SHOWER ROOM:

Double obscure glazed window to side aspect, tiled floor with underfloor heating, ceiling mounted downlighters, luxury contemporary white suite with chrome finished fittings comprising oversized fully tiled walk in shower cubicle with rain head and hand held thermostatic shower fitments, wash hand basin set in vanity unit with mixer tap, tiled splashback and cupboards. Low level wc.

OUTSIDE

The property is set on an enviable corner plot. To the front, there is an extensive blocked paved driveway providing off street parking for several vehicles. Pedestrian entrance gate to Ellsbridge Close and a gate leading to the

SIDE GARDEN

Paved pathway, outdoor power and light and laid mainly to lawn.

REAR GARDEN 13m x 13m (42'7" x 42'7")

Southerly facing, with an extensive paved terrace immediately to the rear of the property ideal for outdoor entertaining with a covered outdoor kitchen area beyond. The garden is level and beyond the terrace laid to lawn with conifer trees and a garden storage shed.

COUNCIL TAX

According to the Valuation Office Agency website, cti.voa.gov.uk the present Council Tax Band for the property is E. Please note that change of ownership is a 'relevant transaction' that can lead to the review of the existing council tax banding assessment.

TENURE

Freehold

ADDITIONAL INFORMATION

The property is offered for sale with solar panels which we understand are leased.

The property has had replacement windows and doors in recent years and the main roof has been replaced.

All mains services.

Mobile - Voice & data coverage likely available externally via EE, O2, Three & Vodafone. Limited internally. Source - Ofcom.

Broadband - Openreach, Truespeed, Virgin Media. Ultrafast up to 1800Mbps available. Source - Ofcom.

